

ARC12 CD/U5

SPECIÁLNÍ PROFIL SPECIAL APPLICATION PROFILE

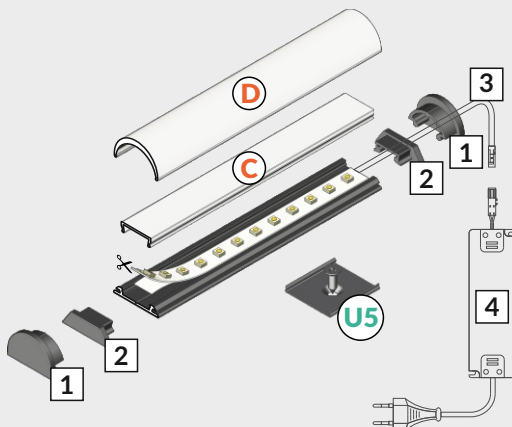
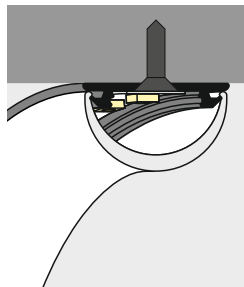
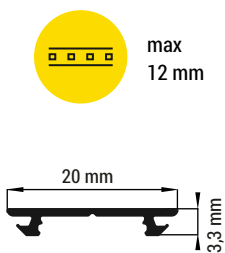

- D** difuzor D klip
D click cover
- C** difuzor C klip
C click cover
- U5** držák U5, otvor
zahluobený
cone U5
mounting plate

- 1** koncovka
ARC 12 typu D
ARC12
D ending
- 2** koncovka ARC12
ARC12 ending
- 3** napájecí kabel
power supply
cable
- 4** LED napájecí
zdroj
LED power
supply



kleště
pliers



pila
hacksaw



páječka
soldering iron



pájka
solder



vrtačka
drill



šroubovák
screwdriver

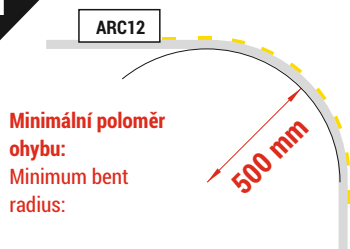

**Minimální poloměr
ohybu:**
Minimum bent
radius:

Pozor! Je-li difuzor na vnější straně
oblouku (obrázek vlevo), musí být
delší než samotný profil.
Note! When bending to the outside
(picture on the left),
the needed length of the cover is
greater than the length of the profile.

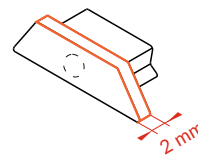
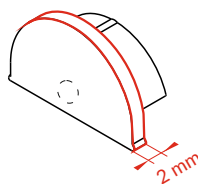

Pozor! Koncovka s označenými
místy pro vrtání otvorů.
Note! Endings with marked
space to bore a hole.

Pozor! S koncovkami se svítidlo prodlouží o 2 mm na každé straně.
Note! Ending thickness increases the length of the luminaire
by 2 mm each side.

RUČNÍ OHÝBÁNÍ / MANUAL BENDING

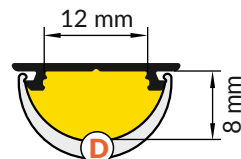
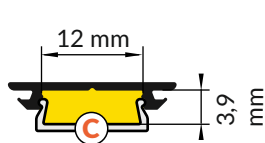
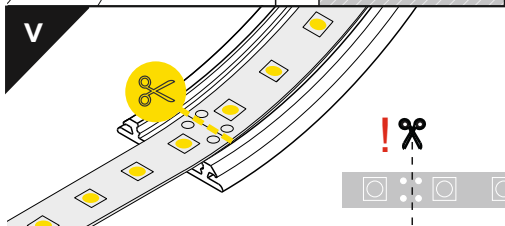
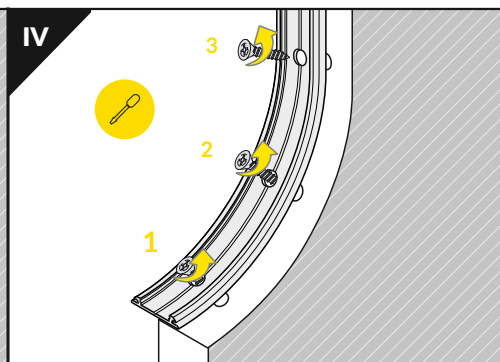
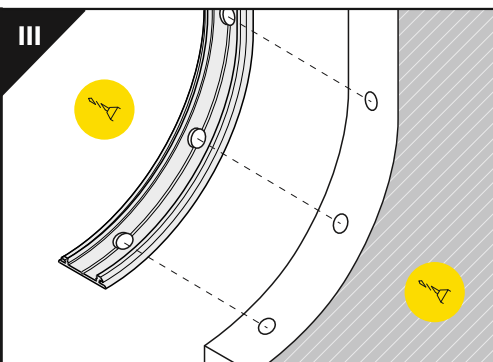
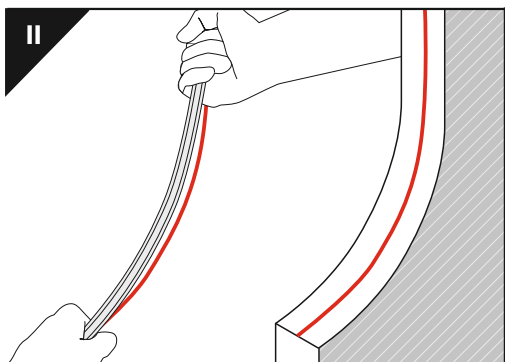

Ověř rozměry prostoru pro LED pásek. / Dimensions of the space to install LED source.

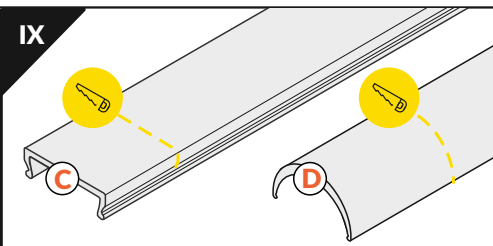
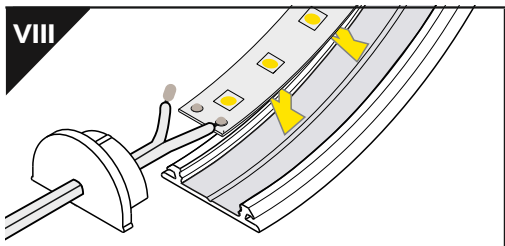
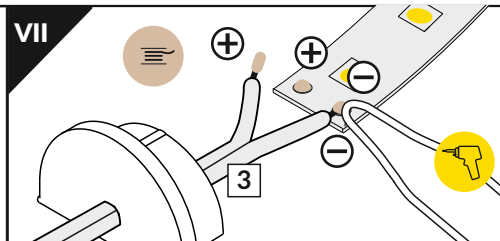
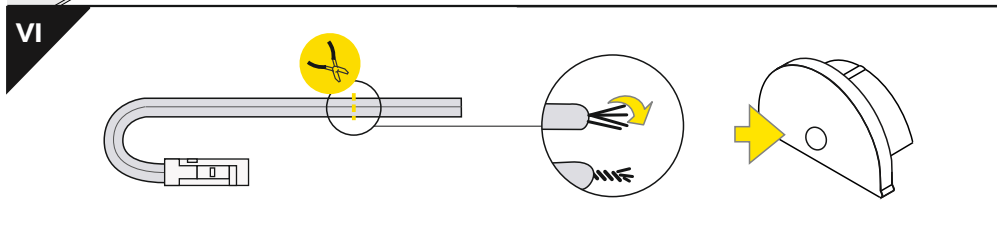

VI

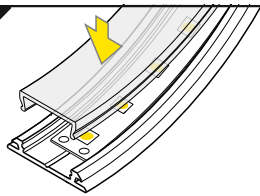

difuzor C klip / C click cover

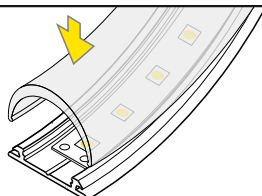

difuzor D klip / D click cover

C + D

oba difuzory: pro maximální rozptýl světla
both covers: for maximum light diffusion

VII MONTÁŽ / MOUNTING

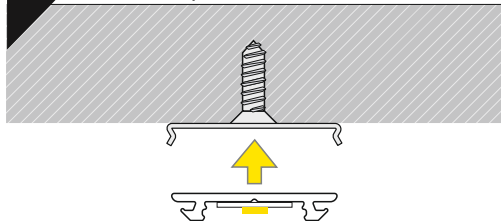
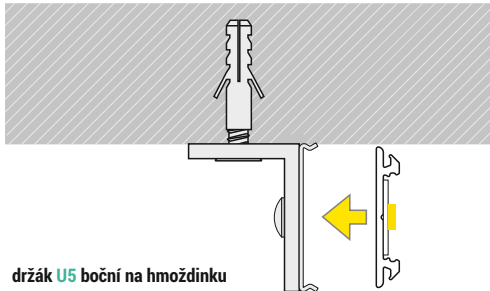
držák U5 otvor zahloubený
cone U5 mounting platedržák U5 boční na hmoždinku
side U5 mounting plate

ZÁVĚS / SLING

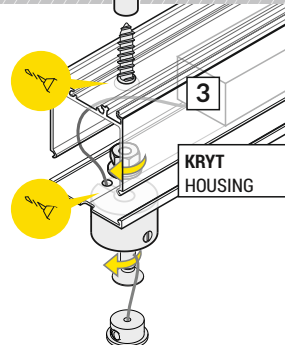
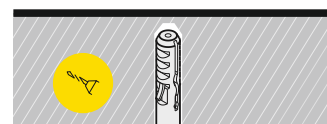
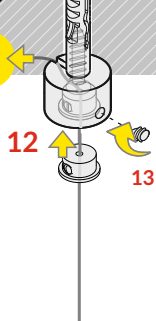
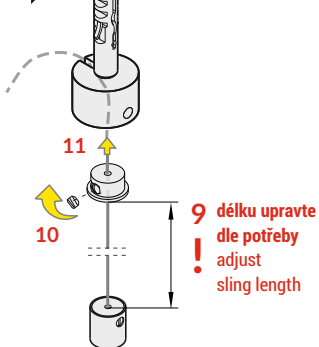
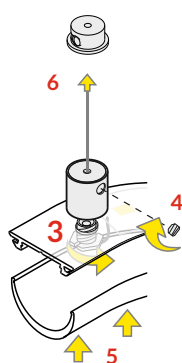
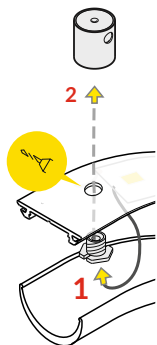
Závěs pro SELV zdroj max. 50V, 1500mm
SELV sling 50V 1500mmzávěs SELV + kryt LED napájecího zdroje
SELV sling + LED power supply housingZávěs pro SELV zdroj max. 50V, 1500mm
SELV sling 50V 1500mm

ARC12

IX

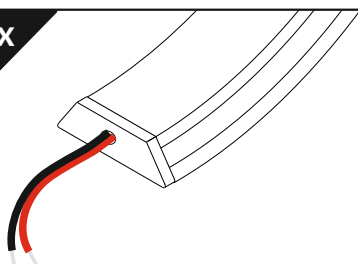

12V/24V

230V

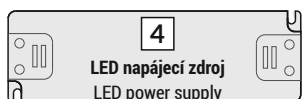

PŘÍSLUŠENSTVÍ / ACCESSORIES

- spínače
- stmívače + ovladače
- pohybové senzory
- power switches
- controller + remote
- movement sensors

Zjistí více - www.tron.cz - TRON katalog LED profilů
Check the rest - www.tron.cz - TRON LED profiles catalogue

TRON

TRON elektronické součástky, s.r.o.

www.tron.cz